

smartNature

Deepti Rajendran, Kevin Liou, Ben Chu,
Andhika Joe

Overview

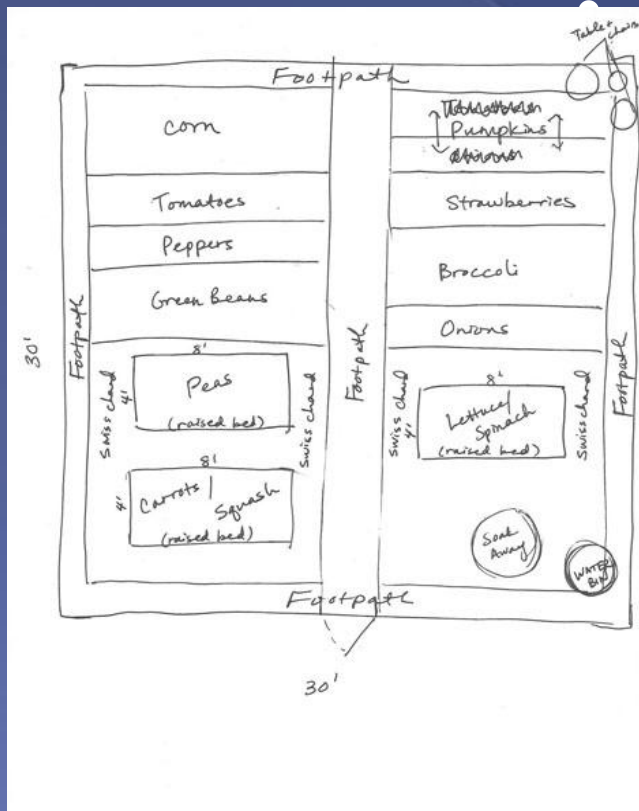

Target Users:

- Professional/ amateur gardeners who need to plan gardens or who need a reference manual

Current Methods:

- Mostly paper sketches
 - Impractical
 - Get lost
 - Inflexible
- Google search for plant info
 - Not specific to plants and desired info

Overall Problem

- How can users keep track off the plants in their garden in a clear organized way?
- Where can they get the information they want to know about plants?
- **Solution: GardenGnome!**



Video Demo



Design

- Add Instructions!

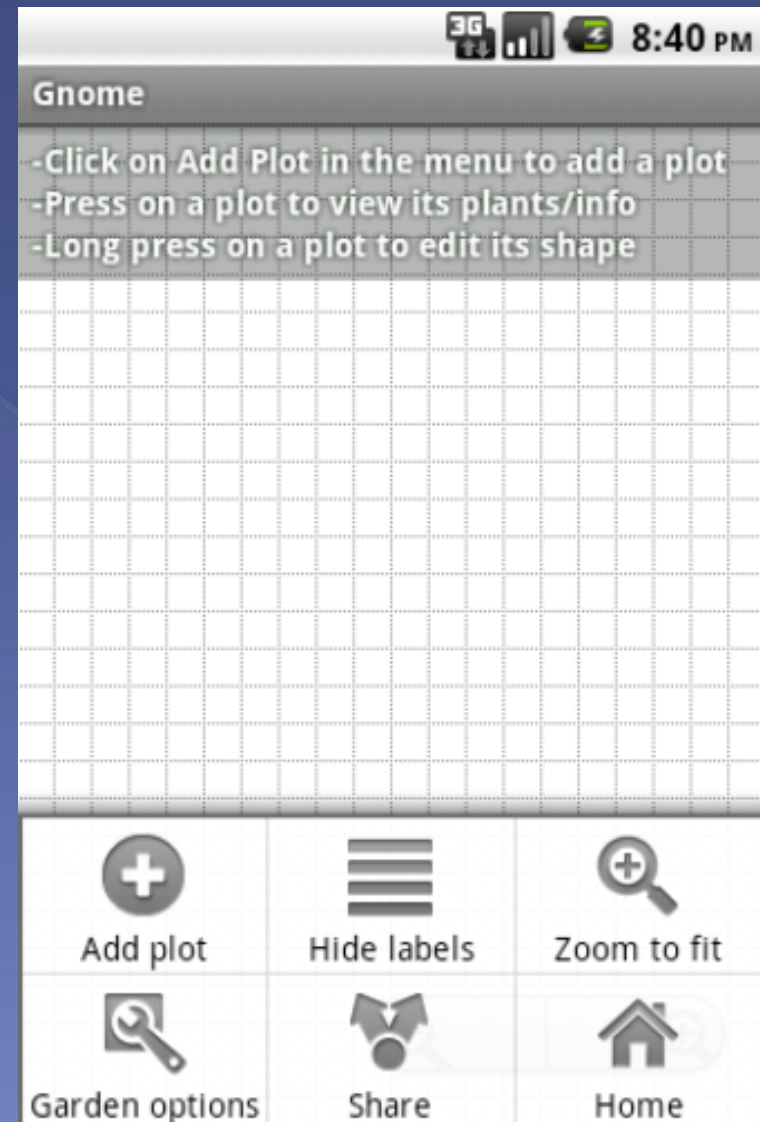
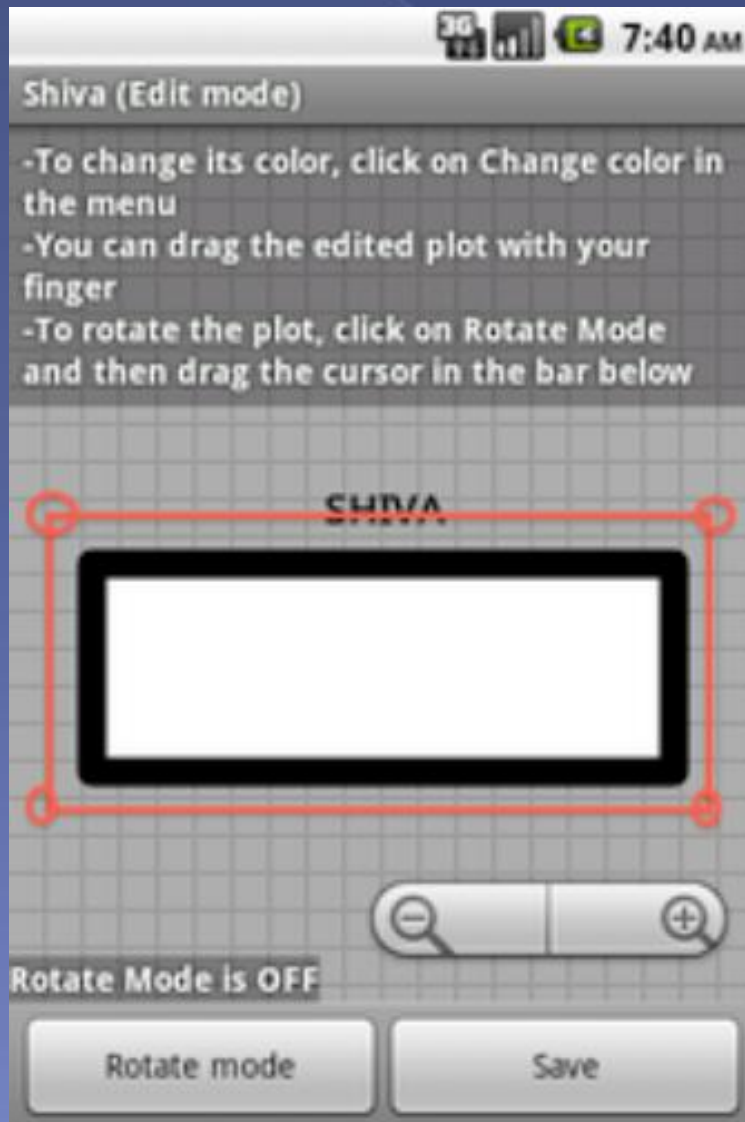

Summary

- Created a combination of a multimedia planting journal, a plant encyclopedia and a garden layout tool
- Provided gardeners a way to organize, learn, and collaborate
- Questions?